

KC Twin Wall Insulated Flue System

- KC has been specifically designed with the installer in mind with a range of installer friendly components.
- KC is quick and easy to install leaving you with a clean lined system to the highest standards.
- The unique, robust jointing system ensures a positive fit on every joint that is secured with a locking band.
- KC with its open ended construction, eradicates the problem of hotspots within the joints leaving a continuous full insulated chimney throughout.

Approvals

HETAS

The official body of certified chimney installers, installers, hangers and services



CE EN 1856-1 : 2003
NO. 0099-CDP-A71-037

Standard Number	Temperature Level	Pressure Level (kPa or h)	Condensate resistance (kWh or kcal or l/h)	Corrosion resistance (DIN 5117)	Flue Liner material specification	Specific resistance (kg per sq cm) & Distance to combustible material (mm)
EN 1856-1	T600	N1	W	VM	L50040	G60

Design & Specification

Working Temperature - 600°C. N1-40pa
Fuels - Gas, Oil, Wood, Coal.

Materials-

Inner wall- Inox Stainless steel AISI 316L
Outer wall- Inox Stainless steel AISI 304BA
Painted (R.A.L. range)

Both the inner and outer wall are 0.4mm thick.
All components are fully welded and insulated with high density Rockwool

The absence of thermal bridges prevents the interior wall of the chimney from cooling down, thus achieving a rapid stable draw and optimum appliance performance. It also prevents the exterior wall from overheating allowing for safe insulation.

The Unique jointing system guarantees a leak proof seal between the components.

All components come with the locking bands. Both 90deg and 135deg Tee's have a Tee Cap included within the price as standard.

KC comes with a 12 year manufacturers warranty

Component Diameters

Dia (mm)	80	100	125	150	175	200	250	300	350
Inner Dia	80	100	125	150	175	200	250	300	350
Outer Dia	130	150	175	200	225	250	300	350	400

Jointing System

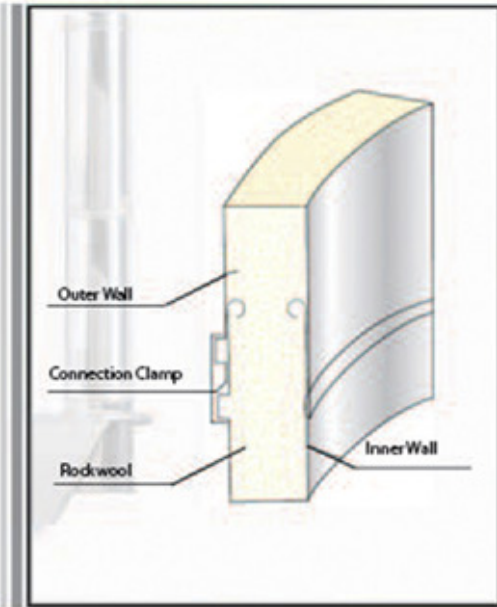

Adaptors

Products (= Chosen Diameter)

Adaptor To SW (Connecting pipe)

Used to start the change from Vitreous enamel to KC

Part No. 10-DDD-001
80Ø 100Ø 130Ø 150Ø
180Ø 200Ø 250Ø



Increasing Adaptor To SW (Connecting pipe)

Used to start the change from Vitreous enamel to KC

Part No. 10-DDD-002
80Ø 100Ø 130Ø 150Ø
180Ø 200Ø 250Ø



Increaser KC to KC

Provides an increase in diameter by one from KC to KC

Part No. 10-DDD-004
80Ø 100Ø 130Ø 150Ø
180Ø 200Ø



Damper Section

The Flue Damper helps regulate draught within the chimney

Part No. 10-DDD-006
80Ø 100Ø 130Ø 150Ø
180Ø 200Ø



Draught Stabiliser
 Part No. 10-DDD-007
 80Ø 100Ø 130Ø 150Ø
 180Ø 200Ø



Straight Lengths

1000mm Pipe Length
A 1000mm fixed straight length

Part No. 10-DDD-010
 80Ø 100Ø 130Ø 150Ø
 180Ø 200Ø 250Ø

500mm Pipe Length
A 500mm fixed straight length

Part No. 10-DDD-011
 80Ø 100Ø 130Ø 150Ø
 180Ø 200Ø 250Ø

250mm Pipe Length
A 250mm fixed straight length

Part No. 10-DDD-012
 80Ø 100Ø 130Ø 150Ø
 180Ø 200Ø 250Ø

Adjustable Pipe Length (350-500)
A straight length which adjusts from 350mm through to 500mm

Part No. 10-DDD-015
 80Ø 100Ø 130Ø 150Ø
 180Ø 200Ø 250Ø

Adjustable Pipe Length (250-350)
A straight length which adjusts from 250mm through to 350mm

Part No. 10-DDD-016
 80Ø 100Ø 130Ø 150Ø
 180Ø 200Ø 250Ø



Elbows & Tees

90° Elbow
 Part No. 10-DDD-030
 80Ø 100Ø 130Ø 150Ø
 180Ø 200Ø 250Ø

45° Elbow
 Part No. 10-DDD-031
 80Ø 100Ø 130Ø 150Ø
 180Ø 200Ø 250Ø

30° Elbow
 Part No. 10-DDD-032
 80Ø 100Ø 130Ø 150Ø
 180Ø 200Ø 250Ø

15° Elbow
 Part No. 10-DDD-033
 80Ø 100Ø 130Ø 150Ø
 180Ø 200Ø 250Ø

135° Tee & Cap
 Part No. 10-DDD-034
 80Ø 100Ø 130Ø 150Ø
 180Ø 200Ø 250Ø



90° Tee & Cap
 Part No. 10-DDD-035
 80Ø 100Ø 130Ø 150Ø
 180Ø 200Ø 250Ø

Tee Cap c/w Drain
 Part No. 10-DDD-037
 80Ø 100Ø 130Ø 150Ø
 180Ø 200Ø 250Ø



Support Items

Locking Bands
Helps to secure two adjoining pipes.
 Part No. 10-DDD-050
 80Ø 100Ø 130Ø 150Ø
 180Ø 200Ø 250Ø

Wall Band (50-80mm)
Used to secure the pipework to the wall

Part No. 10-DDD-051
 80Ø 100Ø 130Ø 150Ø
 180Ø 200Ø 250Ø

Wall Band (80-130mm)
 Part No. 10-DDD-052
 80Ø 100Ø 130Ø 150Ø
 180Ø 200Ø 250Ø

Wall Band (130-210mm)
 Part No. 10-DDD-053
 80Ø 100Ø 130Ø 150Ø
 180Ø 200Ø 250Ø

Adjustable Base Support
Load Bearing Wall Support
 Part No. 10-DDD-060
 80Ø 100Ø 130Ø 150Ø
 180Ø 200Ø 250Ø

Console Plate
 Part No. 10-DDD-061
 80Ø 100Ø 130Ø 150Ø
 180Ø 200Ø 250Ø

Roof Support
 Part No. 10-DDD-067
 80Ø 100Ø 130Ø 150Ø
 180Ø 200Ø 250Ø

Joist Support
 Part No. 10-DDD-068
 80Ø 100Ø 130Ø 150Ø
 180Ø 200Ø 250Ø

Guy Wire Bracket
 Part No. 10-DDD-069
 80Ø 100Ø 130Ø 150Ø
 180Ø 200Ø 250Ø

Firestop Plate
 Part No. 10-DDD-070
 80Ø 100Ø 130Ø 150Ø
 180Ø 200Ø 250Ø

Ventilated Firestop Plate
 Part No. 10-DDD-072
 80Ø 100Ø 130Ø 150Ø
 180Ø 200Ø 250Ø



Terminals

Storm Collar
Part No. 10-DDD-082
80Ø 100Ø 130Ø 150Ø
180Ø 200Ø 250Ø



Cone Top Cowl
Part No. 10-DDD-093
80Ø 100Ø 130Ø 150Ø
180Ø 200Ø 250Ø



Wall Sleeve
Part No. 10-DDD-098
80Ø 100Ø 130Ø 150Ø
180Ø 200Ø 250Ø



Rain Cap
Part No. 10-DDD-090
80Ø 100Ø 130Ø 150Ø
180Ø 200Ø 250Ø



Rotating Cowl
Part No. 10-DDD-094
80Ø 100Ø 130Ø 150Ø
180Ø 200Ø 250Ø



KC To Flex Adaptor
Part No. 10-DDD-099
80Ø 100Ø 130Ø 150Ø
180Ø 200Ø 250Ø



Anti Wind Cowl
Part No. 10-DDD-091
80Ø 100Ø 130Ø 150Ø
180Ø 200Ø 250Ø



Finishing Plate 0-30
Part No. 10-DDD-096
80Ø 100Ø 130Ø 150Ø
180Ø 200Ø 250Ø



Adjustable Wall Sleeve
Part No. 10-DDD-100
80Ø 100Ø 130Ø 150Ø
180Ø 200Ø 250Ø



Gas Cowl
Part No. 10-DDD-092
80Ø 100Ø 130Ø 150Ø
180Ø 200Ø 250Ø



Finishing Plate 30-45
Part No. 10-DDD-097
80Ø 100Ø 130Ø 150Ø
180Ø 200Ø 250Ø



Flex To KC Adaptor
Part No. 10-DDD-101
80Ø 100Ø 130Ø 150Ø
180Ø 200Ø 250Ø



Typical Internal Installation

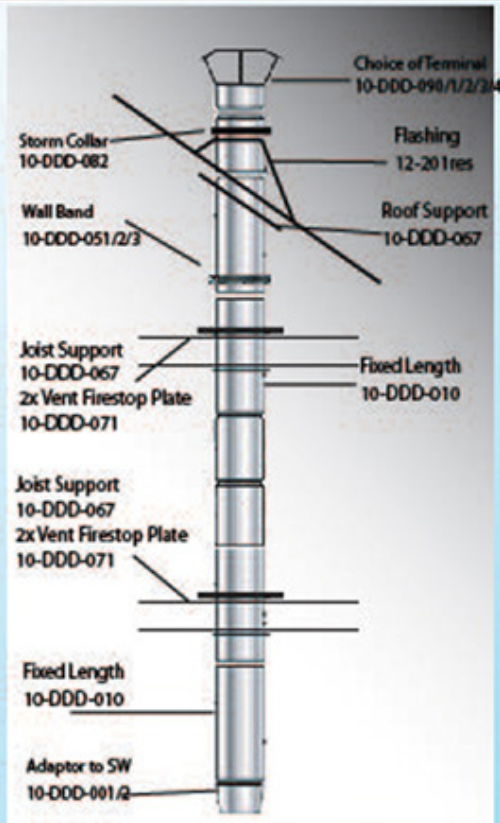

Typical External Installation

